



## July, 2020 Newsletter

Welcome to the July, 2020 newsletter - and Happy 4<sup>th</sup> of July!

Since the last newsletter, 6 more Stingers have been added to the registry, bringing the total to 982.

Buying/selling activity has really picked up in the last month or so as the boating season gets into full swing. I've seen a lot of traffic to the website, and a lot of interest in Stingers. Always good to see that and hope it continues.

Until next month,  
Han

## 1986 Chris-Craft Stinger 260 Wiring Diagrams

This past month, I was lucky enough to get a copy of original wiring diagrams for a 1986 Stinger 260. The wiring diagrams were provided to me by a member who bought his 260 in 1985 – and he's been the only owner ever since.

The wiring diagrams were provided to the member in October, 1988 by Gary Merkley, Electrical Engineer at Chris-Craft.

Note that some of the diagrams provided apply to other models of Stingers including 312s and 314s.

The wiring diagrams are an important source of information for people working on their boats – I've reproduced them here – and have placed them on the website as well under the models section.



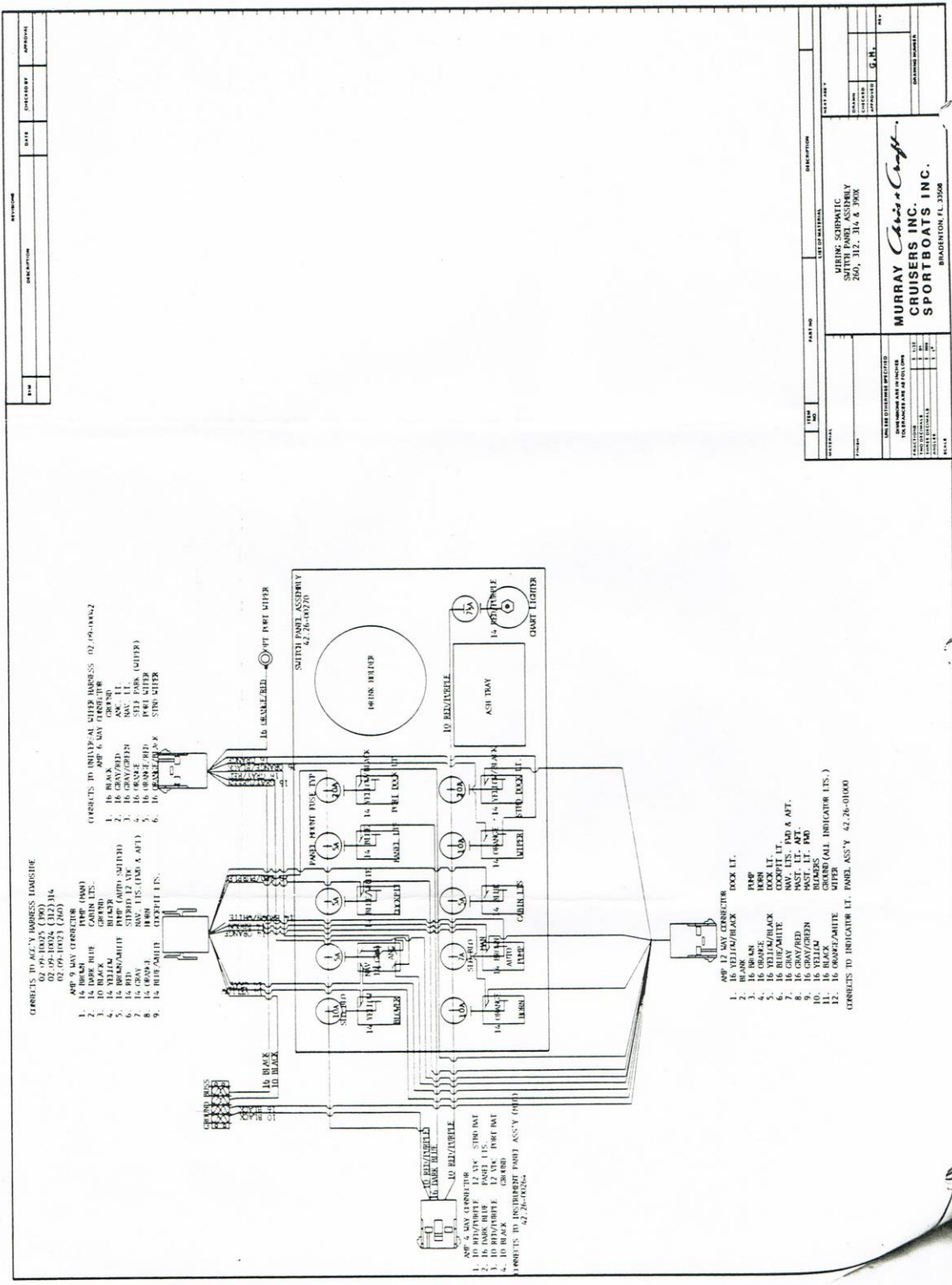

DATE	REVISION

PART NO		DESCRIPTION	REV
42.26-00270		MIRING SCHEMATIC	001
42.26-00270		SWITCH PANEL ASSEMBLY	001
42.26-00270		260, 312, 314 & 3908	001
DATE	REVISION	BY	APPROVED

UNITED STATES PATENT OFFICE  
REGISTERED PATENT OFFICE  
MURRAY CRUISE & YACHT CO., INC.  
260, 312, 314 & 3908  
DADE COUNTY, FLORIDA

**MURRAY Cruise & Yacht**  
**MURRAY CRUISE & YACHT**  
**SPORTS BOATS INC.**  
BRADENDON, FL 33008



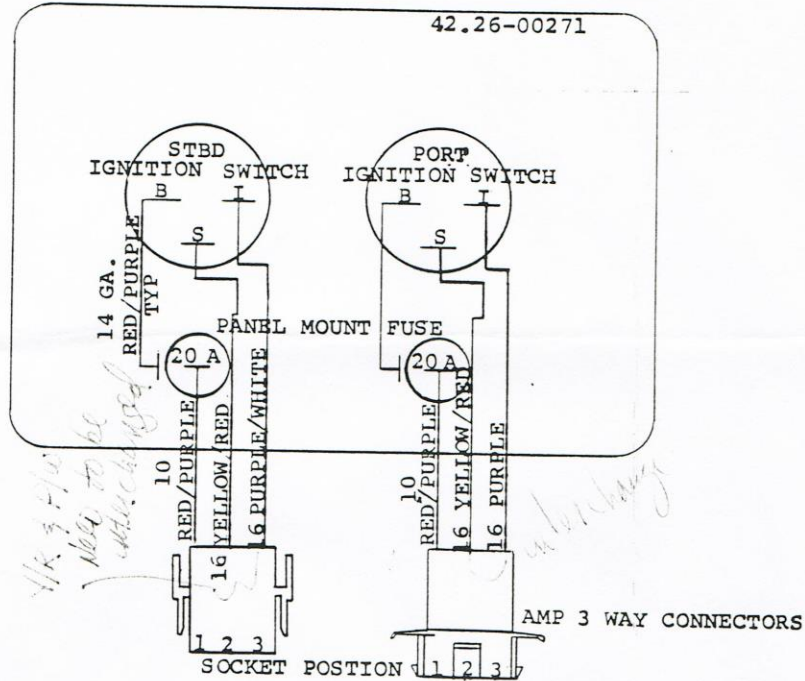

CONNECTS TO 260/312  
INSTRUMENT PANEL ASS'Y  
42.26-00264

ITEM NO.	PART NO.	DESCRIPTION	QTY
MATERIAL		WIRING SCHEMATIC 260/312	
FINISH		IGNITION SWITCH PANEL ASSEMBLY	
UNLESS OTHERWISE SPECIFIED DIMENSIONS ARE IN INCHES TOLERANCES ARE AS FOLLOWS		MURRAY <i>Chris + Craft</i> CRUISERS INC. SPORTBOATS INC. BRADENTON, FL 33506	
FRACTIONS			
TWO DECIMALS			
THREE DECIMALS			
ANGLES			
SCALE			
DRAWN			
CHECKED			
APPROVED		G.M.	
DRAWING NUMBER			

REV.	DESCRIPTION	DATE	CHANGED BY	APPROVAL

INDICATOR LIGHTS TYP.

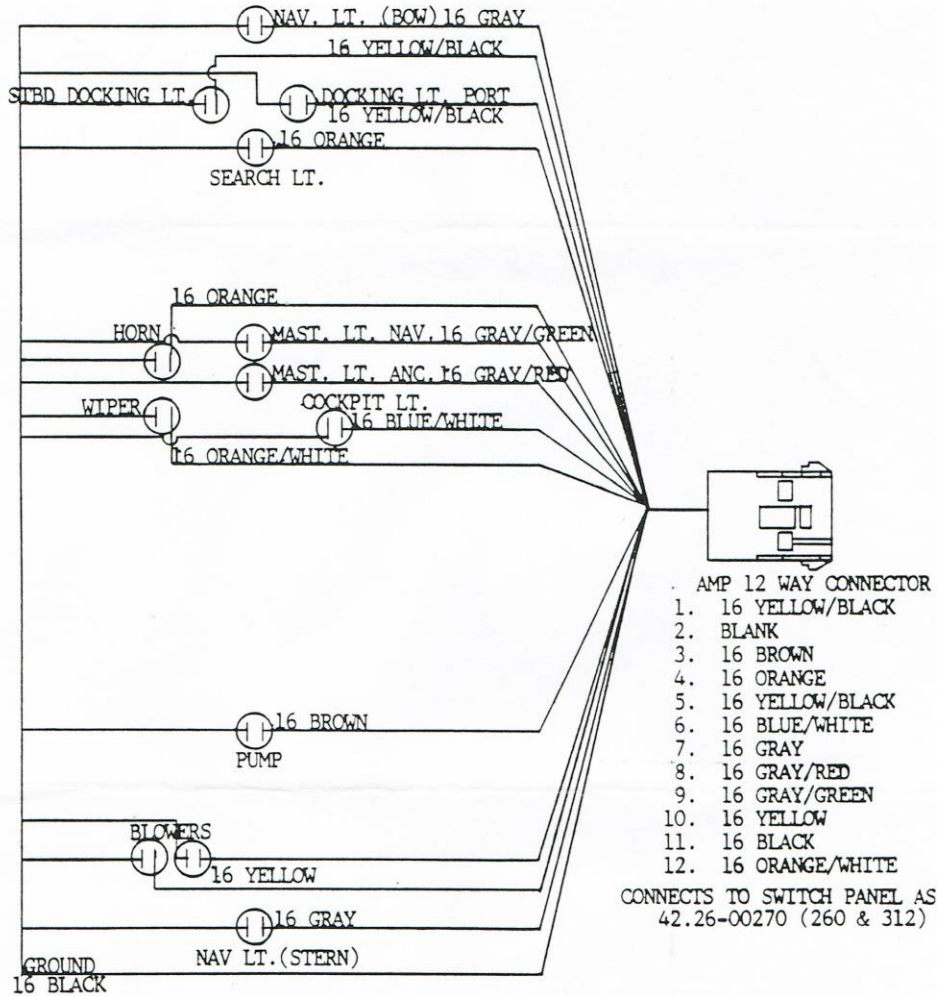

42.26-01000

FORM NO.	PART NO.	DESCRIPTION	REV. NO.
LIST OF MATERIALS			
MATERIAL	WIRING SCHEMATIC		REV. NO.
QUANTITY	INDICATOR LIGHT PANEL		DATE
	260 & 312 314		
USE THE FOLLOWING SPECIFICATIONS: DIMENSIONS ARE IN INCHES UNLESS OTHERWISE SPECIFIED			
FRACTIONS	1/16		
DECIMALS	0.0001		
ANGLES	1/4		
SCALE			
MURRAY <i>Chris-Craft</i> CRUISERS INC. SPORTBOATS INC. BRADENTON, FL. 33608		APPROVED: <i>G.M.</i> DATE:	



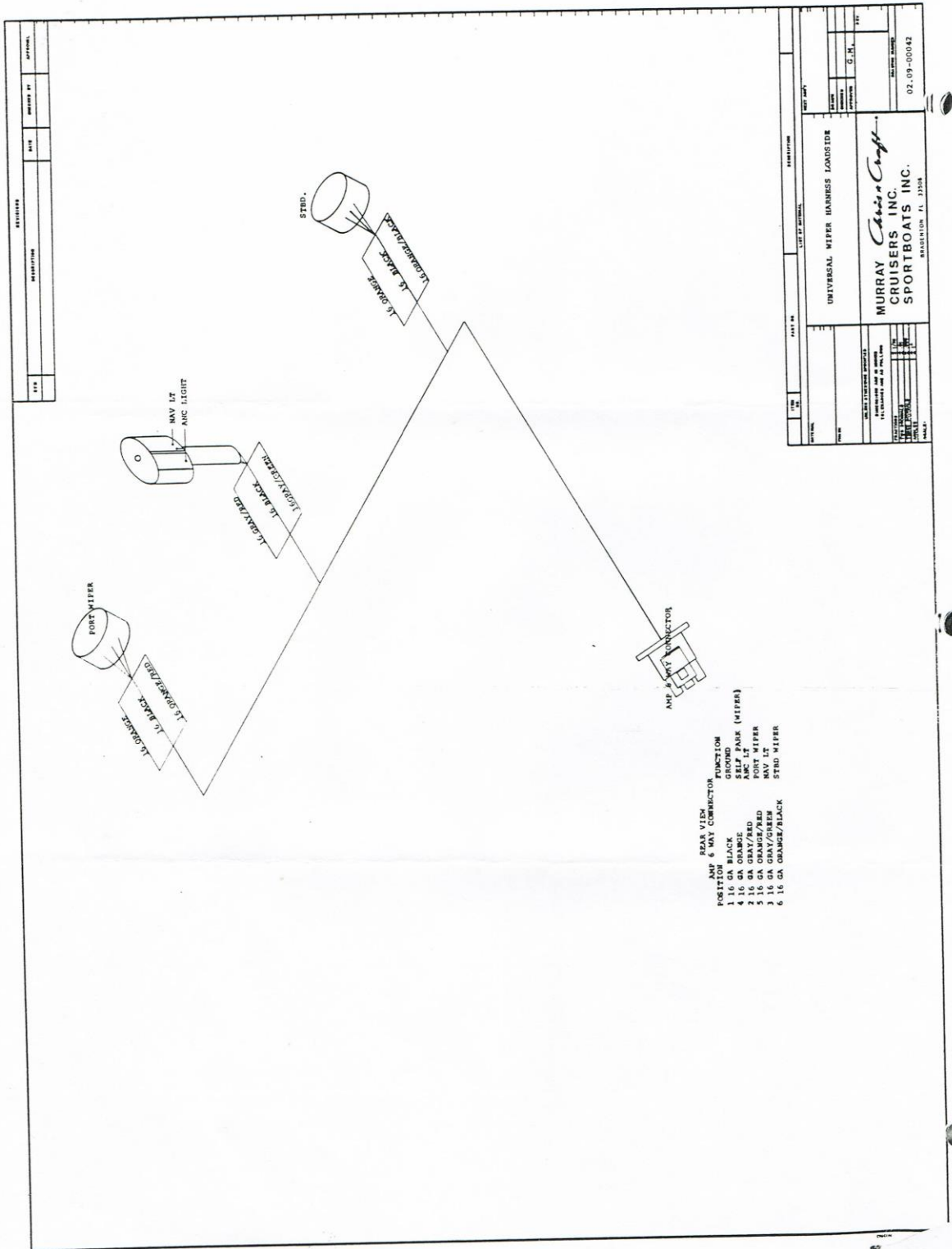

- REAR VIEW**
- AMP 6 NAV CONNECTOR**
- | POSITION | WIRE COLOR         | FUNCTION          |
|----------|--------------------|-------------------|
| 1        | 16 GA BLACK        | GROUND            |
| 2        | 16 GA ORANGE       | SELF PARK (MIFER) |
| 3        | 16 GA GRAY/RED     | ARC LT            |
| 4        | 16 GA GRAY/BLACK   | PORT MIFER        |
| 5        | 16 GA ORANGE/RED   | NAV LT            |
| 6        | 16 GA ORANGE/BLACK | STD MIFER         |

**UNIVERSAL WIPER HARNES LAOSIDER**

**MURRAY Cruisers & Craft**  
**CRUISERS INC.**  
**SPORTBOATS INC.**

WASHINGTON, IL 3104

02-09-00042

DATE: 02/09/02  
DRAWN BY: G.H.L.  
CHECKED BY: G.H.L.  
SCALE: 1:1



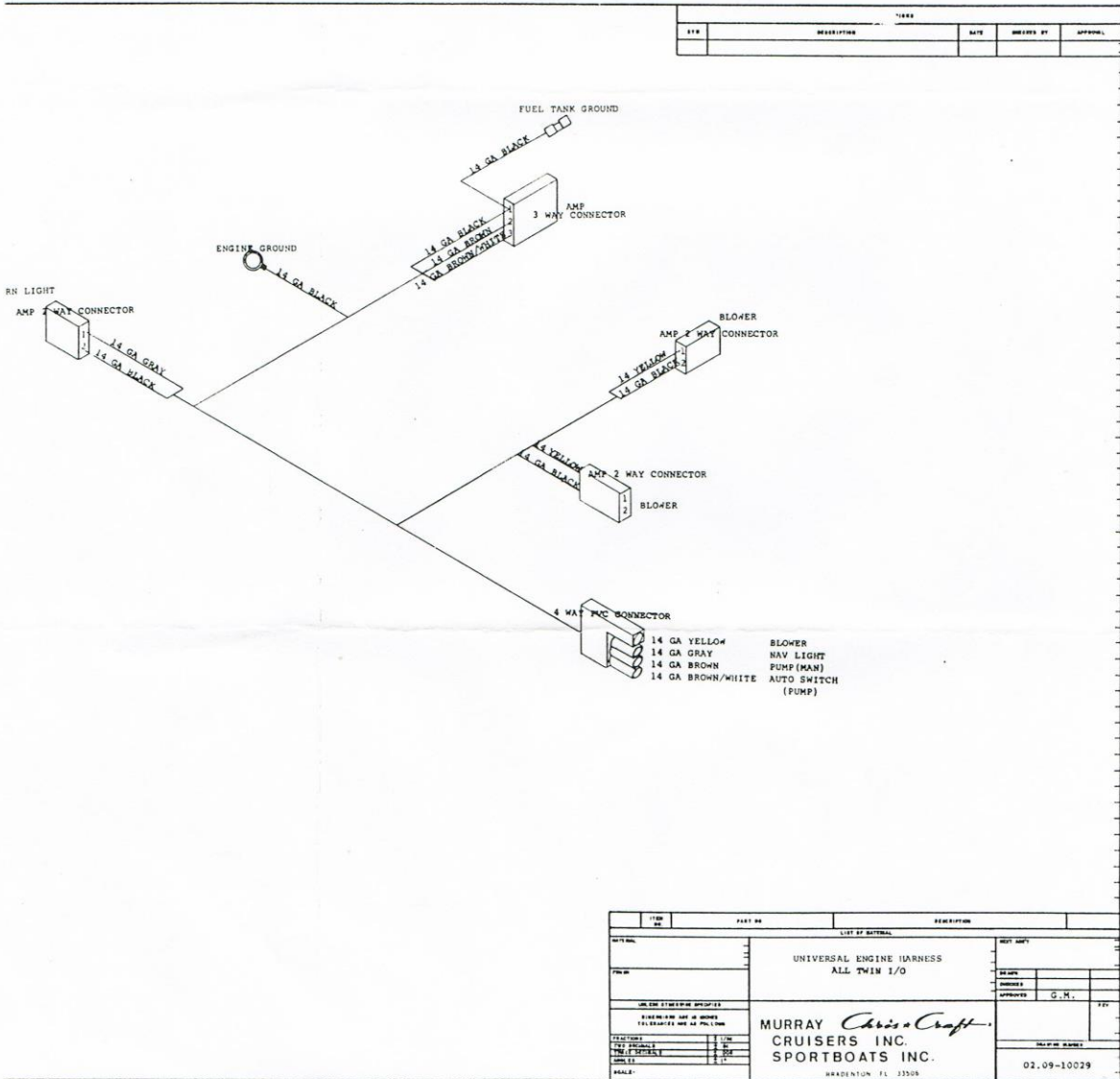

REV	DESCRIPTION	DATE	DRAWN BY	APPROVAL

FORM NO.	PART NO.	DESCRIPTION	REV. SHEET
		UNIVERSAL ENGINE HARNESS ALL TWIN I/O	
MURRAY <i>Chris a Craft</i> CRUISERS INC. SPORTBOATS INC. WRAIDENTON FL 33508		DRAWN CHECKED APPROVED G.M. DATE 02.09-10029	LIST OF MATERIALS PARTS LIST PARTS LIST

# The End of Chris-Craft Third Edition



Han Tunca



*"Brings a whole new light to boating, can't help but think about different parts of the book every time I see a boat."*

*"Sure that anyone interested in this iconic builder would like it."*

[Now Available on Amazon.com](https://www.amazon.com)

## Stingers for Sale

Below is a list of Stingers that have come up for sale during the previous month. The information for each boat in this section accompanied the owner's original advertisement. If you are interested in one of the boats please contact me at [ccstinger@gmail.com](mailto:ccstinger@gmail.com).



**Model: 1983 390**  
**Location: Fowlerville, MI**  
**Asking Price: \$12,000**

1983 Chris Craft Stinger 390X for sale. \$12,000 or best offer. Twin 400 hp mercs. Has been sitting for about 10 years. Recent survey revealed Transom and center stringer will need to be repaired. This boat does run. gauges show good oil pressure in each engine. 320 some hours on each engine and boat. Trailer in good condition.



**Model: 1984 260**  
**Location: Willsboro, NY**  
**Asking Price: \$4,000**

1984 Chris Craft stinger model 260 SL. Twin Mercruiser 260 HP engines. Both engines run very good but one needs a new carburetor. Twin Alpha One drives with stainless steel cleaver propellers. Boat needs work but is usable in current condition. Currently winterized and shrink wrapped but can be seen. Was not used this season. Some cosmetic fiberglass work needed and upholstery needs work. Interior overhead fabric damaged in one spot. No trailer but currently sitting on a yard trailer that may be available. Fun boat to drive. 50 + MPH. Low retail from NADA is \$5610.00. More pictures available.



**Model: 1984 312**  
**Location: Chilliwack, BC, Canada**  
**Asking Price: \$21,500**

32 foot cigarette style off shore boat. New hi performance 454 motors gill exhaust with stainless pipes. Stainless props tie bar counter rotating drives. Incredible rough water boat. Triaxle trailer with new led lights, brakes, and bearings. Own a " Miami Vice Legend."



**Model: 1984 390**  
**Location: Glenwood, IL**  
**Asking Price: \$58,000**

1984 Chris Craft Stinger 390x. original 440 hp cyclone motors rebuilt as roller motors, B&W trans w/ TRS drives, mirage props 367 hr on hull & 60 hrs on rebuilt motors, Stainless Marine Exhaust, Survey done in 2016. Includes a triple axle trailer, excellent paint & interior.



**Model: 1985 260**  
**Location: Orlando, FL**  
**Asking Price: \$7,250**

Essentially this is a "one" Owner Boat as ownership has remained within same family since it was brand new. Here are the particulars:- 1985 Chris Craft Stinger 260 SL - Twin Mercury 260 I/O with Alpha Drives. - Just shy of 800 HRS on Motors. - Stainless Steel Clever Props. - Hull is rock solid with no cracks. - Cabin is good shape. - Boat has been sitting since 2011 and will need some work because of sitting. - Sale includes Aluminum Trailer rebuilt within past 6 months. - Boat is located in Central Florida. - Boat will definitely require some work, but is well worth it. Asking Price is \$ 7,250 OBO



**Model: 1986 222**  
**Location: Brockport, NY**  
**Asking Price: \$6,500**

1986 stinger 222, 350 merc alpha 1 outdrive. Boats in good shape. In the last 3 years transom has been replaced, stringers, bellows, gimbal bearing, coupler, upgraded outdrive Hydraulic pump, impeller, 4 new trailer tires this year. Do your research on these boats rare one of a kind ahead of its time. This one has not been molested and

	<p>turned into something it wasn't meant to be. Make me an Offer.</p>
	<p><b>Model: 1986 222</b>  <b>Location: Benton, LA</b>  <b>Asking Price: \$10,500</b></p> <p>10,500 ... OBO Good solid boat.. Needs a little TLC 454 motor... 4 inch wet jet Needs outdrive seal and upholstery done. 5,000 trailer all aluminum Custom wheels</p>
	<p><b>Model: 1986 260</b>  <b>Location: Ithaca, NY</b>  <b>Asking Price: \$13,500</b></p> <p>Legendary style and performance. Nothing cuts through the water like a Chris-Craft. This boat has twin v8's straight piped above the swim platform. Absolutely beautiful. New port motor, new throttle, new shift cables, new batteries and new master kill switch all within the last 2 years. This boat is a head turner, classic styling with crisp responsive handling. Truly a classic- call today!</p>
	<p><b>Model: 1986 312</b>  <b>Location: Indianapolis, IN</b>  <b>Asking Price: \$16,000</b></p> <p>1986 Chris-Craft 312 Stinger. Twin 454 Mercruisers rebuilt to factory 420 specs. TRS drives with new props. Older repaint &amp; upholstery, 1200-watt inverter in cabin with 110-volt outlets, small sink, refrigerator, porta potty. Very roomy cabin that can sleep 5 if needed, 4 very comfortably. Everything works as should in cabin, CD player with 2 speakers in cabin &amp; 2 outside. Road cover, cockpit cover, bimini top. Shore power hook up, a very solid boat for the year. I removed the arch &amp; still have it. Trailer included. I can text or e-mail pics. Motivated seller, make offer. \$21,500. OBO.</p>
	<p><b>Model: 1986 390</b>  <b>Location: Tulsa, OK</b>  <b>Asking Price: \$4,800</b></p> <p>1986 Chris 39' Stinger. Original was twin big block Chevys with Mercury outdrives. Engines removed years ago to re-power, but project was abandoned, sat under a cover on Long Island for several years. Was a salt boat, now in Oklahoma near lots of water, and it needs a new loving owner to restore and bring back to life. Long and sleek cigarette boat, with its own character! I</p>

trade, but not for junk. NO TRAILER, I might help with re location, in reason.



**Model: 1987 312 Fittipaldi**  
**Location: St Petersburg, FL**  
**Asking Price: \$10,000**

This boat has been in storage for over a decade. It will need a pair of GenIV motors to make it operational. It will come with the Borg-Warner velvet drive transmissions and TRS counter rotating outdrives and stainless props. They have 225 hours on them however they would probably need to be rebuilt given the time they have been in storage. The transom was replaced by Yacht Doctors and the K-Planes were re-installed with custom back plates. The bolsters are in good shape with the exception of the top cushions which can be easily removed. The rear seating will have to be completely redone. The same applies to the cabin area. Traditional U-shaped lounge with berth forward. It's cloth and I would have wanted it in vinyl anyway at some point. The Loadmaster trailer was custom built for the boat as it was on a "high n dry" when I purchased it and all of the tires are brand new. The brakes would need to be replaced. This was one of the few Fittipaldi Equippe models that were produced after Emerson Fittipaldi fell in love with the Stinger model and asked Chris Craft to produce a modified model for him. Consequently they built a handful of these modified Stingers. Very heavy hull and runs like some of the older Formulas. She can run FOT at 72MPH in 3-4' chop with the stock 454 Magnums.



**Model: 1987 314**  
**Location: Soddy-Daisy, TN**  
**Asking Price: \$20,000**

1987 Chris Craft Stinger 314 This has had a lot of work done to it. It's about 75% to 80% complete. The hull has been completely sanded down and refinished from rub rail down. The transom has been completely replaced and reinforced to hold triple 300's. The gill bracket was custom built for the boat. It currently has triple mercury 225 hp. 2-1999 carbureted and 1-2001 fuel injected. The cockpit area has a new custom sun pad creating a very large area for storage and a place to layout. Has new Faria gages and new switches. Triple racing throttle controls. The cabin has been reupholstered 95% complete. Trailer is tri-axle with new wheels and tires new disk brakes and new 20,000lbs surge brake coupler. This boat just needs a little more to be complete. Reason for selling is I bought a bigger fixer-upper and need the money. Asking \$20,000.



**Model: 1988 260**  
**Location: Kingston, NY**  
**Asking Price: \$4,500**

Boat Hull is pretty clean, Imron paint two years prior to me buying her in 2013 (per previous owner), set up for SBC twins and alpha drives, off- color repaint spot, stbd side above rub rail. DOES NOT INCLUDE ENGINES, but includes drives, bennet tabs, all cables, rigging and harnesses in place. Has drop down bolsters with adjustable headrests, but the upholstery is SHOT. the top edges are all split from sun and exposure ( prior to me owning it), no back seat and no sunpad cushions. Cabin cushions are intact and upholstery is good. Through-hull exhaust and integral swim platform. Chris Craft also puts the HIN on the hull itself so you can run it with the platform removed. Includes Boatmaster aluminum double axel trailer, needs new brakes, tires good, 6 lug wheels. I'm open to offers and possible trades (work van?) (big Blocks?). She needs some work but I also restore these and i know what a great boat she will be again, i just happen to own several Stingers and i need to let one or two go.



**Model: 1986 260**  
**Location: Norfolk, VA**  
**Asking Price: \$14,000**

1988 Chris Craft Stinger 260  
The 1988 model line saw a more radically re-styled line of Stingers. This restyling was led by Jim Douglas. These redesigned Stingers sported a curved, windowless, wrap-around windshield, integrated swim platforms, and furnished interiors. These Stingers were some of the last built.



**Model: 1989 385**  
**Location: Patchogue, NY**  
**Asking Price: \$16,995**

1989 38' CHRIS CRAFT STINGER 385 BOATYARD OWNED- Shrink-Wrapped for 3 years. Mercruiser 415HP 454MAG MPI x 2 unknown hours. 2016 2 new Bravo 1 drives, 2017 replaced rear motor mounts, instal block off plates, replace Y-pipes x2, 2 NEW TRANSOME ASSEMBLY,starter x2 , TUNE-UP x 2-16 plugs,wires,cap and rotor, complete cool fuel system x2 plus corrosion mitigation, replaced raw water impellers x2, oil pressure sending units x2, trim tab and drive indicator cables x4, oil and filter and fuel filter x 2. Boat was in the water for 3 months used once and winterized and wrapped for 3 years. Boat will need some tinkering, cleaning, compound wax and maybe some bottom paint. Boat does have AC, SORRY NO TRAILER.



**Model: 1986 222**  
**Location: Buffalo, NY**  
**Asking Price: \$2,500**

Looking to sell my 222. New transom assembly included. Since pics were taken the outdrive bottomed out and broke the gimbal ring. It has a 350 in it. It was winterized 3 years ago. Haven't touched it since. I have paperwork for trailer and boat. Cuddy needs finishing as well as the cockpit. New floor replaced a few years back too. Someone take it off my hands. Make an offer. Located near buffalo ny



**Model: 1987 260**  
**Location: St Louis, MO**  
**Asking Price: \$8,000**

1987 Chris Craft Stinger 260. Twin Mercruiser 260 horse V8's. Alpha drives with stainless props. Boat is in good working order. Everything operates as it should. Interior is old and has a couple cracks in the vinyl but usable. 2006 Rolco dual axle Trailer \$8000.





**Model: 1986 222**  
**Location: Essex, MD**  
**Asking Price: \$8,999**

1986 Chris craft 222 with Center Steering Restored in 2013. 2011 330 hp FWC Engine with less than 30 hours on it 2013 Dual Axel venture trailer Clean title for both boat and trailer Serious buyers only



**Model: 1986 222**  
**Location: Issaquah, WA**  
**Asking Price: \$6,800**

1986 Chris Craft 222 Stinger, owned by the same family for nearly 30 years. 565 hours shown on hour meter, with approximately 300 of those hours since a complete engine and drive replacement in 1997. The boat has only ever been in fresh water. Always kept on a lift inside a boathouse, or stored indoors when not in the water. The boat is incredibly fast and very fun to drive. The exterior of the hull has been bumped up against its fair share of fenders and docks and shows plenty of scratches and scrapes. All damage is cosmetic though, not structural. The interior is in good condition with no rips or tears in the upholstery. There is seating for 3 up front, while the rear deck to both sides of the engine compartment can be converted into two additional individual seats. Brand new WA boat tabs just installed. New Interstate MTP-27 battery June 2020. A stainless 3 blade Spinelli Brothers round ear custom propeller is installed and a spare prop is included. Includes tandem axle trailer with new tires in 2019, new master cylinder, and wheel bearings having just been inspected and repacked with fresh grease. Cash only - no trades



**Model: 1983 312**  
**Location: Lorain, OH**  
**Asking Price: \$10,000**

312 stinger part out bravo outdrives and 454 engines run. soft spots in transom let me know what parts you need for pricing located in lorain Ohio



**Model: 1985 312**  
**Location: Lake Havasu, AZ**  
**Asking Price: \$17,000**

I have a 1985 Chris Craft Stinger for sale. If you know about the boat you know what i have. Clean boat. Head turner. Text or call for more info. 2087713288 6/8/2020: 1985 chris craft stinger. Always a fresh water boat. 370 Horse power big block chevys, 72C transmissions, TRS outdrives, motors run but are tired and need to be rebuilt. Outdrives and transmissions are in excellent condition. Three axle trailer, titles in hand. \$17,000 cash.